

Dimensionamenti ASME B16.34 / EN 12569 / API 608/ EN 17292 / ASME VIII DIV.1 / EN 12516-1

Estremità flangiate ASME B16.5 Cl. 150/300 EN 1092-1 PN 10/16/25/40 DIN 2632 / 2633 / 2634 / 2635

Collaudo ASME B16.104 API 598 EN 12266-1 ISO 5208 BS 6755-1

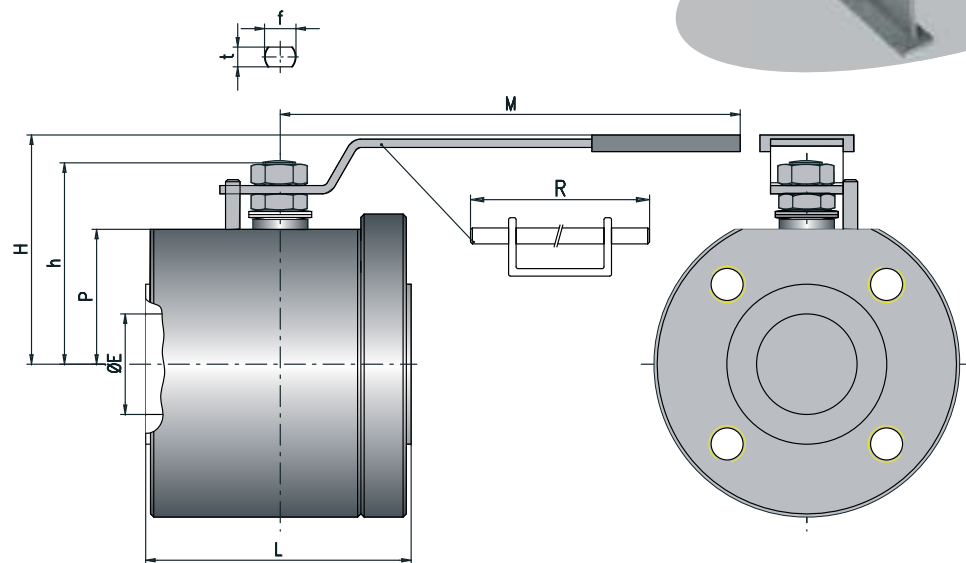

Dimensioni - outline dimensions

	DN	15	20	25	40	50	80	100	150
	Ø"	1/2"	3/4"	1"	1 1/2"	2"	3"	4"	6"
ANSI 150	ØE	14	19	24	38	48	75	95	152
	L	55	60	60	80	95	121	152	240
PN10-16	P	34	36	50	63	72	93	105	154
	h	53	55	69	96	102	128	152	220
	H	85	87	95	119	127	148	184	273
	M	151	151	186	275	275	380		
	R							440	715
	f/t	10/6	10/6	12/8	16/10	16/10	22/14	30/18	45/30
	ISO 5211	F03	F03	F03	F05	F05	F07	F10	F14
	Ø"	1/2"	3/4"	1"	1 1/2"	2"	3"	4"	6"
ANSI 300	ØE	14	19	24	38	48	75	95	152
	L	55	60	65	85	100	145	185	280
PN25-40	P	34	36	50	63	75	92	105	154
	h	53	55	69	96	102	128	152	220
	H	85	87	95	119	125	149	184	273
	M	151	151	186	275	275	380		
	R							440	715
	f/t	10/6	10/6	12/8	16/10	16/10	22/14	30/18	45/30
	ISO 5211	F03	F03	F03	F05	F05	F07	F10	F14

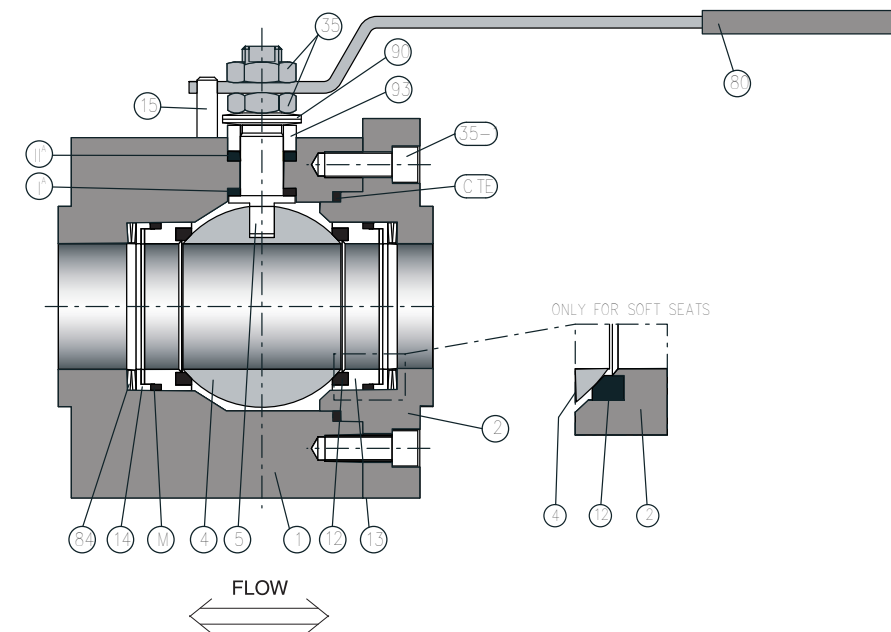
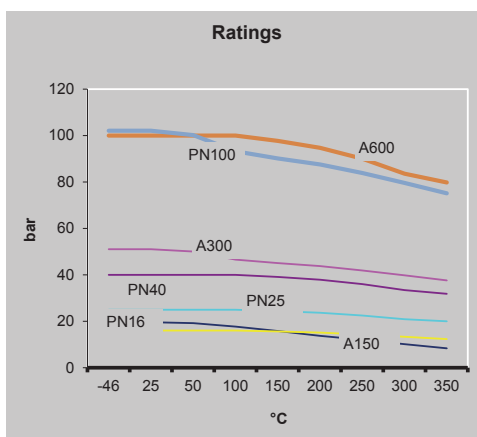

Materiali base - base materials

CTE	Guarnizione Corpo / Terminale	Body / Connector Gasket	Grafoil
M	Guarnizione Retroseggio	Seat Gasket	Grafoil
II ^	Guarnizione Secondaria	Secondary Stem Seal	Grafoil
I ^	Guarnizione Primaria	Primary Stem Seal	Grafoil
93	Premi Baderna	Gland	316 s.s.
90	Molle Stelo	Stem Spring	301 s.s.
84	Molle Seggio	Seat Spring	301 s.s. / X750
80	Leva	Lever	Fe 37 UNI 7070
35-1	Bulloneria Corpo / Terminale	Body / Connector Bolts	304 s.s.
35	Dadi Stelo	Nut	304 s.s.
15	Fermo Leva	Lever Stopper	UNI 3740 Gr.8.8
14	Premigrafoil	Compression Ring	316 s.s.
13	Cassetto	Seat Holder	316 s.s.
12	Seggio	Seat Insert	PENTAFITE ST6 CRC- WC RPTFE
5	Stelo	Stem	A564 Tp.630 (17/4PH)
-	Rivestimento Sfera	Ball Coating	HCR/HTC ST6 WC/CRC
4	Sfera	Ball	316 s.s.
2	Terminale	Body Connector	A105 316 s.s.
1	Corpo	Body	A105 316 s.s.

P. No. Parte - Part Name

Materiali - Material

Altre estremità disponibili su richiesta - Other end connections available on request

HTC = Nitruri di Titanio (Titanium Nitrides); HCR = Nitruri di Cromo (Chrome Nitrides); ST6 = Stellite 6 Detonation Gun/HVOF; WC = Carburi di Tungsteno (Tungsten Carbides Detonation Gun/HVOF); CRC = Carburi di Cromo (Chrome Carbides Detonation Gun/HVOF)